

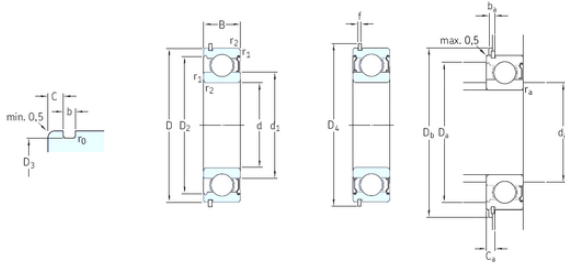

BEARINGS IMPORTED AND EXPORTED CO.,LTD.



65 mm x 120 mm x 23 mm SKF 6213-ZNR deep groove ball bearings

Bearing No. 6213-ZNR

6213-ZNR Bearing 2D drawings and 3D CAD models

Size	65x120x23 mm
Bore Diameter	65 mm
Outer Diameter	120 mm
Width	23 mm
d	65 mm
D	120 mm
B	23 mm
C	23 mm
b	3,1 mm
d1	83,3 mm
f	2,82 mm
r0 max.	0,6 mm
r1 min.	1,5 mm
r2 min.	1,5 mm
C	4,06 mm
D2	106 mm
D3	115,21 mm
D4	129,7 mm
ba min.	6,88 mm
Ca max.	6,88 mm
da min.	3,5 mm
da max	83,2 mm
Da max.	111 mm
Db min.	131 mm
ra max.	1,5 mm



BEARINGS IMPORTED AND EXPORTED CO.,LTD.

Weight	1,05 Kg
Basic dynamic load rating (C)	58,5 kN
Basic static load rating (C0)	40,5 kN
Fatigue load limit (Pu)	1,73
Reference speed	12000 r/min
Limiting speed	7500 r/min
Calculation factor (f0)	15
Category	Single Row Ball Bearings
Inventory	0.0
Manufacturer Name	SKF
Minimum Buy Quantity	N/A
Weight / Kilogram	1.09
EAN	7316577738233
Product Group	B00308
Enclosure	1 Metal Shield
Precision Class	ABEC 1 ISO P0
Maximum Capacity / Filling Slot	No
Rolling Element	Ball Bearing
Snap Ring	Yes
Internal Special Features	No
Cage Material	Steel
Internal Clearance	C0-Medium
Inch - Metric	Metric
Long Description	65MM Bore; 120MM Outside Diameter; 23MM Outer Race Diameter; 1 Metal Shield; Ball Bearing; ABEC 1 ISO P0; No Filling Slot; Yes Snap Ring; No Internal Special Features
Category	Single Row Ball Bearing
UNSPSC	31171504
Harmonized Tariff Code	8482.10.50.68



BEARINGS IMPORTED AND EXPORTED CO.,LTD.

Noun	Bearing
Keyword String	Ball
Manufacturer URL	http://www.skf.com
Manufacturer Item Number	6213-ZNR
Weight / LBS	2.4
Outer Race Width	0.906 Inch 23 Millimeter
Outside Diameter	4.724 Inch 120 Millimeter
Bore	2.559 Inch 65 Millimeter
d_1	83.3 mm
D_2	105.8 mm
D_3	115.21 mm
D_4	129.7 mm
r_0 max.	0.6 mm
$r_{1,2}$ min.	1.5 mm
d_a min.	74 mm
d_a max.	83.2 mm
D_a max.	111 mm
D_b min.	131 mm
b_a min.	3.5 mm
C_a max.	6.88 mm
r_a max.	1.5 mm
Basic dynamic load rating C	58.5 kN
Basic static load rating C_0	40.5 kN
Fatigue load limit P_u	1.73 kN
Calculation factor k_r	0.025
Calculation factor f_0	14.7
Mass bearing	1.07 kg
Snap ring	SP 120